

BMDA SERIES ALUMINUM DOUBLE ACTING CYLINDER

CAPACITY: 20-150T
 MAX. PRESSURE: 700 Bar
 HYDRAULIC RETURN



FEATURES AND BENEFITS

- Double-acting for rapid retraction, regardless of hose lengths or system losses
- Composite bearings increase cylinder life and sideload resistance
- Hard-Coat finish on all surfaces resists damage and extends cylinder life
- Handles included on all models
- Steel base plate and saddle for protection against load-induced damage
- Integral stop ring prevents plunger over-travel and is capable of withstanding the full cylinder capacity
- Built-in safety valve prevents accidental over-pressurization.

Tilt Saddle Selection

Cylinder Model	Saddle Model	Saddle Diam. J1	Saddle Protrusion K1
	mm	mm	mm
BMDA-50	STG-50	50	24
BMDA-100	STG-100	73	29
BMDA-150	STG-150	91	31

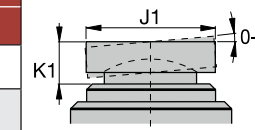

Base Steel Plate

Cylinder Model	Bolt Circle U	Thread V	Thread Depth Z
	mm	mm	mm
BMDA-20	93	M6	12
BMDA-30	105	M6	12
BMDA-50	110	M6	12
BMDA-100	165	M6	12
BMDA-150	200	M6	12

Including 6mm plate thickness



All BMDA-cylinders are equipped with bolt-on removable saddles of hardened steel.

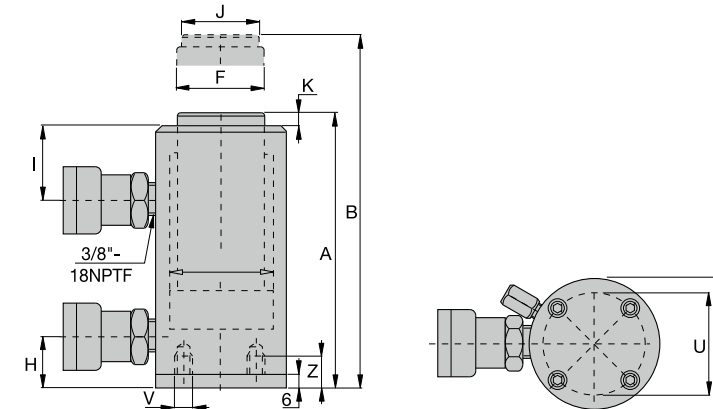

Model	Capacity @10,000 PSI (700 bar)	Stroke	Cylinder Capacity (KN)		Effective Area (cm ²)		Oil Capacity (cm ³)	
			Push	Pull	Push	Pull	Push	Pull
			ton	mm	mm	mm	mm	mm
BMDA-202	20	50	218	130	31.2	18.6	156	93
BMDA-204		100	218	130	31.2	18.6	312	186
BMDA-206		150	218	130	31.2	18.6	468	279
BMDA-208		200	218	130	31.2	18.6	624	372
BMDA-2010		250	218	130	31.2	18.6	780	465
BMDA-302	30	50	309	179	44.2	24.5	221	123
BMDA-304		100	309	179	44.2	24.5	442	245
BMDA-306		150	309	179	44.2	24.5	663	368
BMDA-308		200	309	179	44.2	24.5	884	490
BMDA-3010		250	309	179	44.2	24.5	1105	613
BMDA-502	50	50	496	187	70.9	26.7	354	134
BMDA-504		100	496	187	70.9	26.7	709	267
BMDA-506		150	496	187	70.9	26.7	1063	401
BMDA-508		200	496	187	70.9	26.7	1417	534
BMDA-5010		250	496	187	70.9	26.7	1771	668
BMDA-1002	100	50	1002	557	143.1	79.5	715	398
BMDA-1004		100	1002	557	143.1	79.5	1431	795
BMDA-1006		150	1002	557	143.1	79.5	2147	1193
BMDA-1008		200	1002	557	143.1	79.5	2863	1590
BMDA-10010		250	1002	557	143.1	79.5	3578	1988
BMDA-1502	150	50	1589	924	227	132	1135	660
BMDA-1504		100	1589	924	227	132	2270	1320
BMDA-1506		150	1589	924	227	132	3405	1980
BMDA-1508		200	1589	924	227	132	4540	2640
BMDA-15010		250	1589	924	227	132	5675	3300

Closed Height	Extended Height	Outside Diam.	Bore Diam.	Piston Diam.	Bottom to Oil Port	Top to Oil Port	Saddle Diam.	Saddle Protrusion	Weight	Model
A	B	D	E	F	H	I	J	K	kg	
mm	mm	mm	mm	mm	mm	mm	mm	mm		
189	239	113	63	40	30	50	30	3	7.4	BMDA-202
239	339	113	63	40	30	50	30	3	8.0	BMDA-204
289	439	113	63	40	30	50	30	3	8.6	BMDA-206
339	539	113	63	40	30	50	30	3	9.2	BMDA-208
389	639	113	63	40	30	50	30	3	9.8	BMDA-2010
201	251	125	75	50	30	55	40	3	8.6	BMDA-302
251	351	125	75	50	30	55	40	3	9.5	BMDA-304
301	451	125	75	50	30	55	40	3	10.4	BMDA-306
351	551	125	75	50	30	55	40	3	11.3	BMDA-308
401	651	125	75	50	30	55	40	3	12.2	BMDA-3010
201	251	145	95	75	30	56	50	3	11.1	BMDA-502
251	351	145	95	75	30	56	50	3	12.7	BMDA-504
301	451	145	95	75	30	56	50	3	14.3	BMDA-506
351	551	145	95	75	30	56	50	3	15.9	BMDA-508
401	651	145	95	75	30	56	50	3	17.5	BMDA-5010
251	301	185	135	90	43	80	75	3	16.4	BMDA-1002
301	401	185	135	90	43	80	75	3	19.3	BMDA-1004
351	501	185	135	90	43	80	75	3	22.2	BMDA-1006
401	601	185	135	90	43	80	75	3	25.1	BMDA-1008
451	701	185	135	90	43	80	75	3	28.0	BMDA-10010
248	298	230	170	110	38	75	113	3	24.2	BMDA-1502
298	398	230	170	110	38	75	113	3	28.9	BMDA-1504
348	498	230	170	110	38	75	113	3	33.2	BMDA-1506
398	598	230	170	110	38	75	113	3	37.9	BMDA-1508
448	698	230	170	110	38	75	113	3	42.6	BMDA-15010

Safety Practices
 Good industry practice recommends not exceeding 80% of the max. rated capacity.

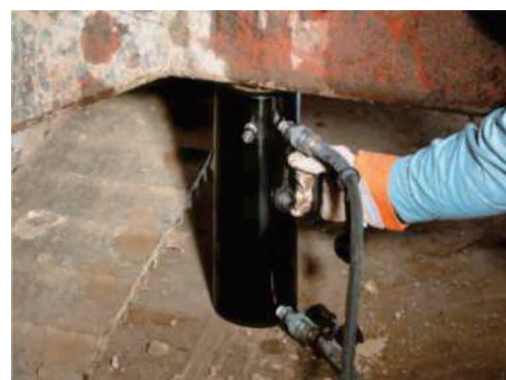

A BMDA-506 was easy to position under a bulldozer for repair of frame member